

MAVIC Crossmax Elite 29

ASTM CATEGORY 3 : offroad with jumps less than 61cm
Recommended weight limit : 120kg
Recommended tyre sizes: 28 mm to 62 mm (1.1" to 2.5")

REFERENCES WHEELS

F55101	XmaxElite29FWTSBlack	F69841	XmElite29FiSpWTS Black
F55102	XmaxElite29FWTSRed	P83171	XmaxElite29PrWTSBlack
F69831	XmElite29FiBoostWTSBlack	P83181	XmaxElite29PrWTSRed
F69832	XmElite29FiBoostWTSRed		

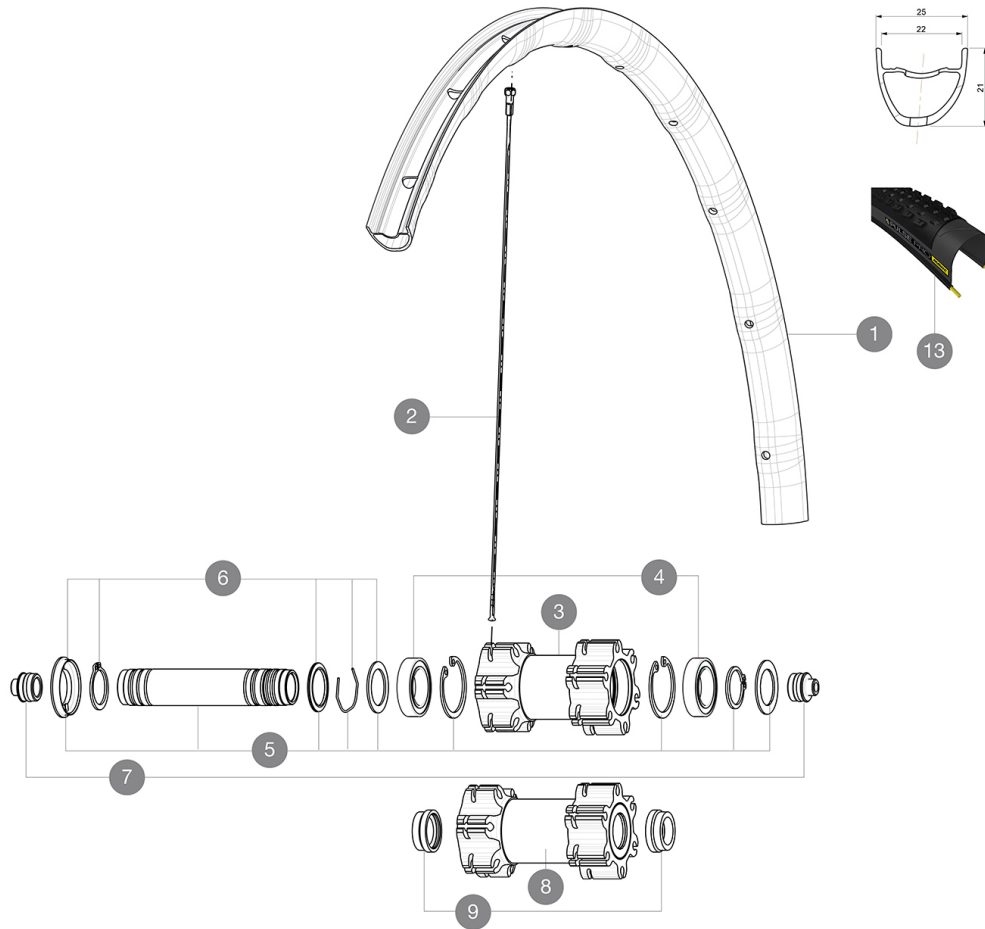

RIMS



Ø VALVE HOLE (MM): 6,5 :

1	V3150115	SET Front/Rear rim XMAX ELITE 29" 22TSS red
1	V3130115	SET Front/Rear rim XMAX ELITE 29" 22TSS black

SPOKES

2	V2381401	12 REAR DRIVE SIDE SPOKES 295mm CROSSRIDE TUBELESS 29
---	----------	---

MOYEURS

3	N/A	HUB BODY
3	N/A	HUB BODY
4	99688501	BEARING KIT 9/15 D6T HUB
5	V2370101	KIT FRONT AXLE 15MM CROSSONE/CROSSRIDE/CROSSROC
6	V2370301	FRONT AUTO ADJUST.PLAY KIT 15MM AXLE
7	B4104401	15mm FT Road Axle Adapters 16
8	N/A	HUB BODY
8	N/A	HUB BODY
10	V2371301	YELLOW AXLE SUPPORTS FRONT BOOST 110mm FOR SELF ADJUSTING
11	N/A	AXLE SYSTEM
12	M40771	BEARING KIT FOR LEFTY HUB
13	36709301	ASSEMBLY KIT CROSSROC SUPERMAX

TYRES

14	39243221	Pulse Pro 29" 2.1
14	39243232	Pulse Pro 29" 2.25

MAVIC Crossmax Elite 29

DELIVERED WITH

Front QR adapters (996 941 01 for MTB or B41 043 01 for road) 1	
Rear 12x142mm adapters for Instant Drive 360 (B49 896 01 for ID360 6T, B49 899 01 for ID360 CL) 1	
Rear 12x142mm adapters for ITS4 and TS2 (308 593 01 for ITS4, 329 650 01 for TS2) 1	

COMPATIBILITY

Freewheel: Shimano/Sram, convertible to XD with optional driver body	
Front axle: convertible from 15mm thru axle to Quick Release with included adapters	
Rear axle: 12mm thru axle, convertible to Quick Release with optional adapters	

Specifications

WHEEL HUB

- Front and rear bodies : aluminum

WHEEL WEIGHTS

Wheel weight 785

VERSIONS

- Color : Black or Black/Red
- Disc standard : 6 Bolts only
- Hub width : Boost (front 110, rear 148) or Non-Boost (front 100, rear 135/142)
Lefty Supermax