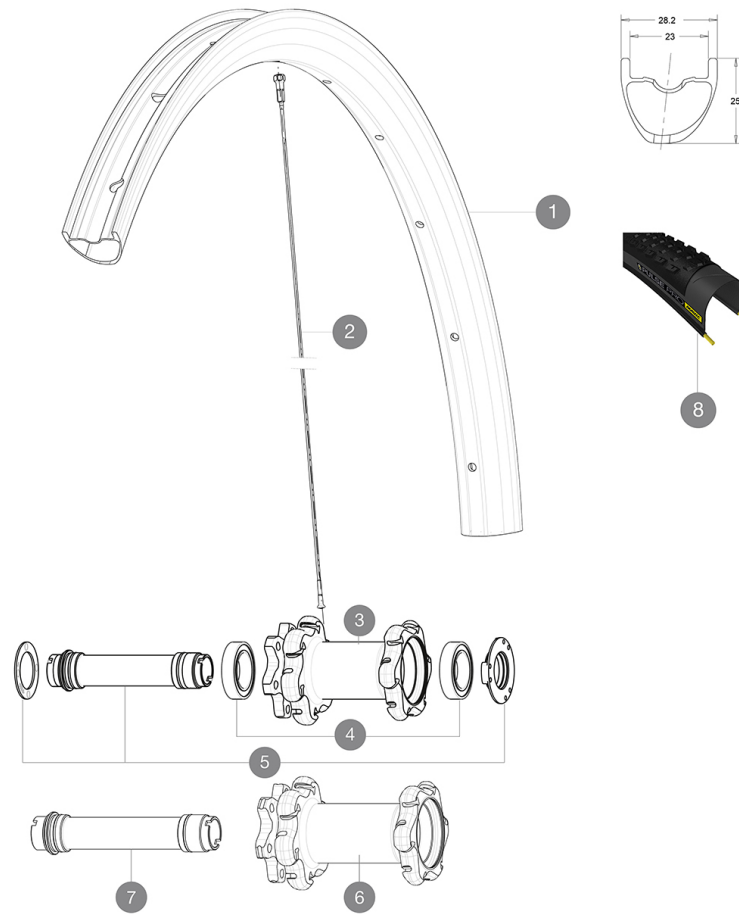

MAVIC **Crossmax Pro Carbon 27.5**

ASTM CATEGORY 3 : offroad with jumps less than 61cm
 Recommended weight limit : 120kg
 Recommended tyre sizes: 28 mm to 62 mm (1.1" to 2.5")
 Recommended tyre sizes: 35 mm to 69 mm (1.4" to 2.7")

REFERENCES WHEELS

| | | | |
|--------|--------------------------|--------|-----------------------|
| F63301 | XmProCarb27.5FitBoostWTS | P83071 | XmaxProCarb27.5PrWTS |
| F70921 | XmProCarb27.5FitSpXWTS | F54601 | XmaxProCarb27.5FitWTS |

**RIMS**

Ø VALVE HOLE (MM): 6,5 :

| | | |
|---|----------|-------------------------------------|
| 1 | V3260110 | SET Front rim XMAX PRO CARBON 27,5" |
|---|----------|-------------------------------------|

SPOKES

| | | |
|---|----------|---|
| 2 | V2384401 | KIT 12 FRONT + REAR NON-DRIVE SIDE BUTTED SPOKES 274mm CROSSMAX PRO CARBON 27,5" |
|---|----------|---|

MOYEURS







| | | |
|---|----------|---------------------------------------|
| 3 | N/A | HUB BODY |
| 4 | 99688501 | BEARING KIT 9/15 D6T HUB |
| 5 | V2252301 | MY16 FRONT AXLE ROAD DISC 9/12/15 INT |
| 6 | N/A | HUB BODY |
| 7 | V2370701 | KIT FRONT QRM+ AXLE BOOST INTL 110mm |

TYRES

| | | |
|---|----------|----------------------|
| 8 | 39243132 | Pulse Pro 27,5" 2.25 |
| 8 | 39243121 | Pulse Pro 27,5" 2.1 |

MAVIC Crossmax Pro Carbon 27.5

DELIVERED WITH

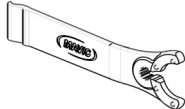
| | |
|---|---|
| 1 bottle of Mavic Sealant (355 466 01) 1 |  |
| BX601 quick releases (V24 503 01 frt, V24 504 01 rear) 1 |  |
| Front QR adapters (996 941 01 for MTB or B41 043 01 for road) 1 |  |
| Rear 12x142mm adapters for Instant Drive 360 (B49 896 01 for ID360 6T, B49 899 01 for ID360 CL) 1 |  |
| Rear 12x142mm adapters for ITS4 and TS2 (308 593 01 for ITS4, 329 650 01 for TS2) 1 |  |
| UST valve and accessories (129 838 01) |  |
| Specific disc bolts (308 719 01) Pack of 6 |  |
| Tubeless rim tape | |
| Multifonction adjustment wrench (325 423 01) 1 |  |
| User guide | |

COMPATIBILITY

| | |
|---|--|
| Freewheel: Shimano/Sram, convertible to XD with optional driver body | |
| Front axle: convertible from 15mm thru axle to Quick Release with included adapters | |
| Rear axle: 12mm thru axle, convertible to Quick Release with optional adapters | |

Specifications

RIMS

- **Material** : 100% Unidirectional carbon fiber
 - **Drilling** : traditional
 - **Valve hole diameter** : 6.5 mm
 - **Tyre** : UST Tubeless and tubetype
 - **Internal width** : 23 mm
 - **ETRTO size 27.5"** : 584x23ss
 - **ETRTO size 29"** : 622x23ss
- Hookless profile
Use with Mavic Tubeless Tape

SPOKES

- **Material** : steel
- **Shape** : straight pull, bladed, double butted
- **Count** : 24 front and rear
- **Lacing** : front and rear crossed 2

WHEEL HUB

- **Front and rear bodies** : aluminum
 - **Axle material** : aluminum
- Adjustable sealed cartridge bearings
- **Freewheel** : ITS-4 alloy

VERSIONS

- **Color** : Black only
 - **Disc standard** : 6 Bolts only
 - **Hub width** : Boost (front 110, rear 148) or Non-Boost (front 100, rear 135/142)
- Lefty Supermax

WHEEL WEIGHTS

Wheel weight
Weight Front 27.5": 680
Weight Front 29": 700