

ASTM CATEGORY 2 : road and offroad with jumps less than 15cm
Recommended weight limit : 120kg
Recommended tyre sizes: 25 to 52 mm
Max. Pressure: 25mm 7.7 bars - 110 PSI

REFERENCES WHEELS

P65701	KsyriumElite16Pr Black	P82904	Ksyrium Elite 16 Pr White
P65702	KsyriumElite16Pr Red	R96841	KsyriumElite16RrSMUG16-71
P65703	KsyriumElite16Pr Blue	R99811	Ksy Elite16Rr NT SMU BK
P65704	KsyriumElite16Pr White	R66701	KsyriumElite16Rr Black
P82901	Ksyrium Elite 16 Pr Black	R66702	Ksyrium Elite 16Rr Red
P82902	Ksyrium Elite 16 Pr Red	R66703	Ksyrium Elite 16Rr Blue
P82903	Ksyrium Elite 16 Pr Blue	R66704	Ksyrium Elite 16Rr White

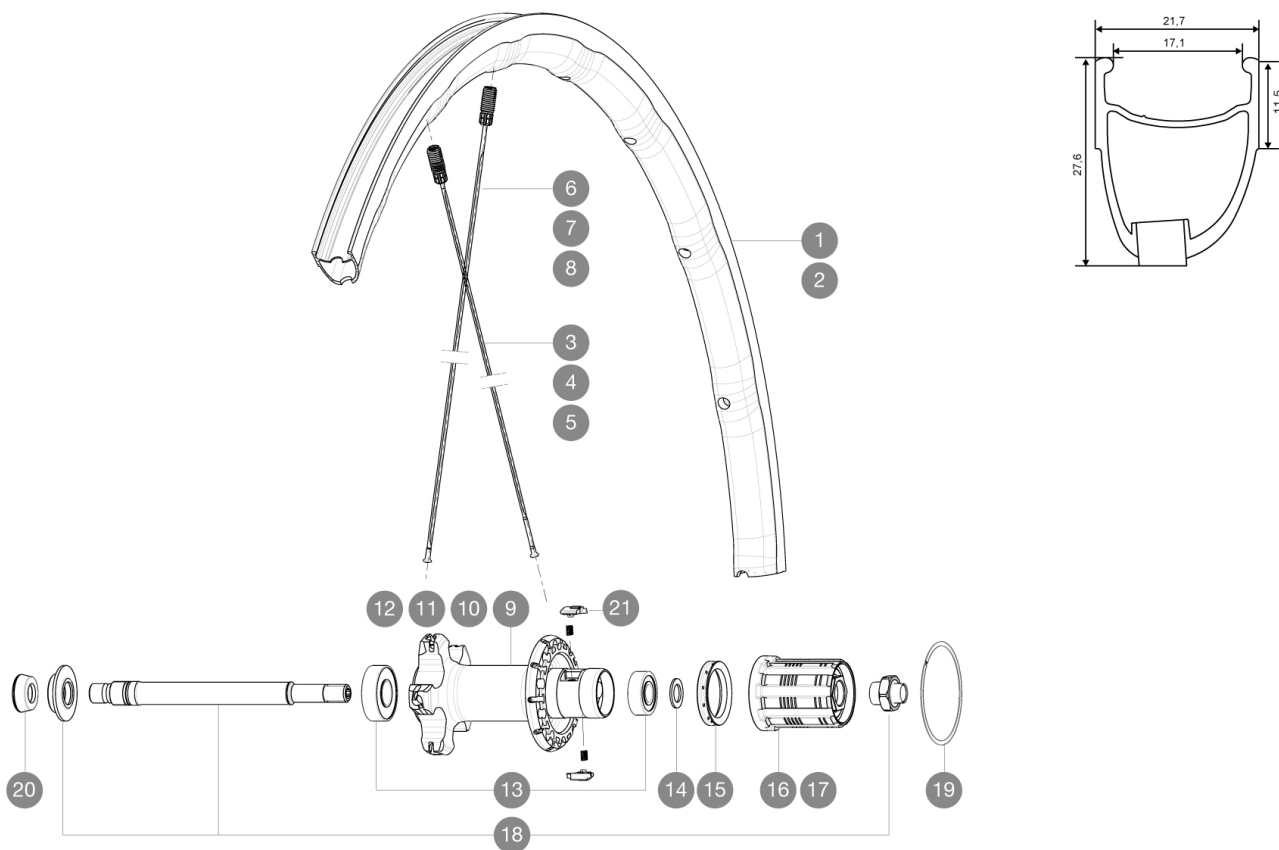

RIMS



VALVE HOLE Ø (MM): 6,5 :

1	V2402313	KIT REAR RIM KSYRIUM ELITE 2016 BLACK for BLACK/RED/BLUE
2	V2404813	REAR RIM KSYRIUM ELITE WHITE 16

SPOKES

3	V2271701	KIT 10 REAR DRIVE SIDE SPOKES 273,5mm KSYRIUM ELITE for BLACK/WHITE
4	V2272301	KIT 10 REAR DRIVE SIDE SPOKES 273,5mm KSYRIUM ELITE RED
5	V2272001	KIT 10 REAR DRIVE SIDE SPOKES 273,5mm KSYRIUM ELITE BLUE
6	V2271801	KIT 10 REAR NON-DRIVE SIDE SPOKES 299,5mm KSYRIUM ELITE for BLACK/WHITE
7	V2272401	KIT 10 REAR NON-DRIVE SIDE SPOKES 299,5mm KSYRIUM ELITE RED
8	V2272101	KIT 10 REAR NON-DRIVE SIDE SPOKES 299,5mm KSYRIUM ELITE BLUE

MOYEURS

9	N/A	HUB BODY
10	N/A	HUB BODY
11	N/A	HUB BODY
12	N/A	HUB BODY
13	V2540101	REAR HUB 609+6001 BEARINGS 2015
14	30872801	SET OF 3 INTERNAL SILVER SPACERS 9mm FTS-L 2013
15	99500001	FTSL/FTSX FREEHUB BODY SEAL
16	30871101	FTS-L FREEWHEEL BODY HG11 2013 (8 or 9mm axle compatible)
17	30871201	FTS-L FREEWHEEL BODY ED11 2013 (8 or 9mm axle compatible)

18	V2250501	Axle Kit Ksyrium Elite / SLS
19	V2252201	ID360 2 REAR HUB RETENTION RING
20	35117301	FRONT OR REAR FORK REST KIT R-SYS 2013
21	M40578	FTSL PAWLS KIT (ROAD WHEELS)

MAVIC Ksyrium Elite

DELIVERED WITH

BR301 quick releases	
BR301 quick releases	
Multifonction adjustment wrench	
User guide	
Multifonction adjustment wrench	
User guide	

COMPATIBILITY

Freewheel: Shimano/Sram, convertible to Campagnolo with optional driver body	
Front axle: Quick Release only	
Rear axle: Quick Release only	

Specifications

RIMS

- **Material** : Mxstal
- **Height** : front 24mm, rear 26 asymmetrical
- **Joint** : SUP
- **Drilling** : Fore
- **Brake track** : UB Control
- **Weight reduction** : ISM 4D
- **Valve hole diameter** : 6.5 mm
- **Material** : Mxstal
- **Tyre** : clincher
- **Height** : front 24mm, rear 26 asymmetrical
- **ETRTO size** : 622x17C
- **Recommended tyre sizes** : 25 to 52 mm
- **Joint** : SUP
- **Drilling** : Fore
- **Brake track** : UB Control
- **Weight reduction** : ISM 4D
- **Valve hole diameter** : 6.5 mm
- **Tyre** : clincher
- **Internal width** : 17 mm
- **ETRTO size** : 622x17C

SPOKES

- **Material** : steel
- **Shape** : straight pull, bladed, front double butted
- **Nipples** : Fore integrated aluminum
- **Count** : front 18, rear 20
- **Material** : steel
- **Lacing** : front radial, rear Isopulse
- **Shape** : straight pull, bladed, front double butted
- **Nipples** : Fore integrated aluminum
- **Count** : front 18, rear 20
- **Lacing** : front radial, rear Isopulse

WHEEL HUB

- **Front and rear bodies** : aluminum
- **Axle material** : aluminum
- Adjustable sealed cartridge bearings
- **Freewheel** : FTS-L steel
- **Front and rear bodies** : aluminum
- **Axle material** : aluminum
- Adjustable sealed cartridge bearings
- **Freewheel** : FTS-L steel

VERSIONS

- **Color** : Black or Black/Red or Black/Blue or Black/White

WHEEL WEIGHTS

Wheel weight 870