

ASTM CATEGORY 3 : offroad with jumps less than 61cm  
Recommended weight limit : 120kg  
Recommended tire sizes: 35 mm to 69 mm (1.4" to 2.7")

## REFERENCES WHEELS

F70311	XA Elite27,5Ft Boost BK	P83191	XA Elite 27,5 Pr Black
F70312	XAElite27,5FtBoost Green	P83201	XA Elite 27,5 Pr Green
F70313	XA Elite27,5Ft Boost Blue	P83401	XA Elite 27,5Pr Blue
F70321	XA Elite27,5Ft Spx Black	F70211	XA Elite 27,5 Ft Black
F72131	XaEl27.5Ft15x110NTSMU Red	F70212	XA Elite 27,5 Ft Green
F72191	XaEl27.5Ft131x110NTSMU	F70213	XA Elite 27,5 Ft Blue

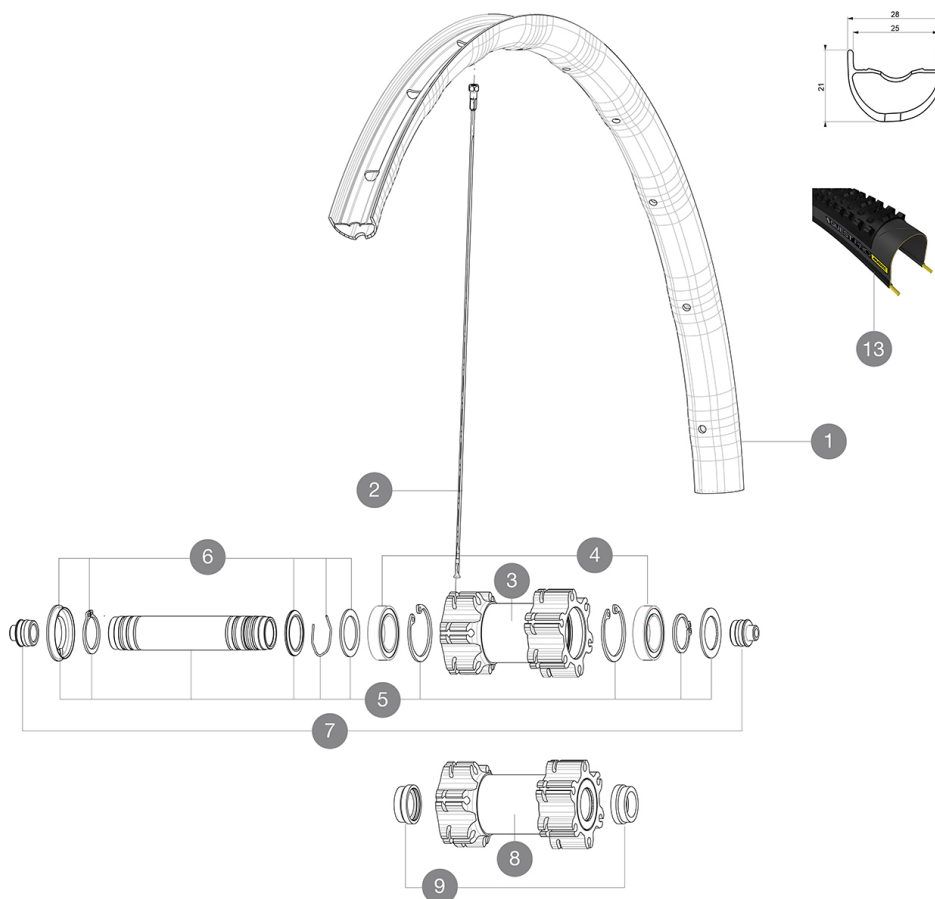

## RIMS



Ø VALVE HOLE (MM): 6,5 :

1	V3200115	SET Front/Rear rim XA ELITE 27,5" 25TSS blue
1	V3180115	SET Front/Rear rim XA ELITE 27,5" 25TSS green
1	V3160115	SET Front/Rear rim XA ELITE 27,5" 25TSS black

## SPOKES

2	V2382401	12 FRT + REAR NON-DRIVE SIDE SPOKES 279mm CROSSRIDE
---	----------	---

## MOYEURS

3	N/A	HUB BODY
3	N/A	HUB BODY
3	N/A	HUB BODY
4	99688501	BEARING KIT 9/15 D6T HUB
5	V2370101	KIT FRONT AXLE 15MM CROSSONE/CROSSRIDE/CROSSROC
6	V2370301	FRONT AUTO ADJUST.PLAY KIT 15MM AXLE
7	B4104401	15mm FT Road Axle Adapters 16
8	N/A	HUB BODY
8	N/A	HUB BODY
8	N/A	HUB BODY
9	V2371301	YELLOW AXLE SUPPORTS FRONT BOOST 110mm FOR SELF ADJUSTING
10	N/A	AXLE SYSTEM
11	M40771	BEARING KIT FOR LEFTY HUB







12 36709301 ASSEMBLY KIT CROSSROC SUPERMAX

## TYRES

13	39243324	Quest Pro 27,5x2.40
----	----------	---------------------

# MAVIC XA Elite

## DELIVERED WITH

1 bottle of Mavic Sealant (355 466 01) 1	
BR101 quick releases (M40350 firt, M40351 rear road, M40352 rear MTB) 1	
Front QR adapters (996 941 01 for MTB or B41 043 01 for road) 1	
Rear QR adapters (308 731 01) 1	
Rear 12x142mm adapters for ITS4 and TS2 (308 593 01 for ITS4, 329 650 01 for TS2) 1	
UST valve and accessories (129 838 01)	
Tubeless rim tape	

## COMPATIBILITY

Freewheel: Shimano/Sram, convertible to XD with optional driver body	
Front axle: convertible from 15mm thru axle to Quick Release with included adapters	
Rear axle: convertible from Quick Release to 12mm thru axle with included adapters	

## Specifications

### RIMS

- **Material** : Maxtal
- **Joint** : SUP
- **Drilling** : traditional
- **Weight reduction** : ISM 4D
- **Valve hole diameter** : 6.5 mm
- **Tire** : UST Tubeless and tubetype
- **Internal width** : 25 mm
- **ETRTO size 27.5"** : 584x25ss
- **ETRTO size 29"** : 622x25ss

Hookless profile  
Use with Mavic Tubeless Tape

### SPOKES

- **Material** : steel
- **Shape** : straight pull, bladed, double butted
- **Count** : 24 front and rear
- **Lacing** : front and rear crossed 2

### WHEEL HUB

- **Front and rear bodies** : aluminum
- **Axle material** : aluminum
- Sealed cartridge bearings
- **Freewheel** : ITS-4 alloy

### VERSIONS

- **Color** : Black or Black/Blue or Black/Green
- **Disc standard** : 6 Bolts only
- **Hub width** : Boost (front 110, rear 148) or Non-Boost (front 100, rear 135/142)
- Lefty Supermax

### WHEEL WEIGHTS

Wheel weight  
Weight Front 27.5": 780  
Weight Front 29": 815